

Power Jacks

POWER JACKS LTD.
 "SYM-METRIC"
 RANGE OF CUBIC METRIC ACTUATORS
 DESIGNED AND MANUFACTURED IN THE UK
 200 KN RATED CAPACITY
 STANDARD TRANSLATING SCREW WITH ANTI-BACKLASH
 65mm DIA. X 12mm PITCH MACHINE SCREW

ST200-****-E1RR-CPC100B (THREADED END)
 ST200-****-T1RR-CPC100B (TOP PLATE)
 ST200-****-C1RR-CPC100B (CLEVIS END)

**** = RAISE IN MM
 REFER TO PRODUCT CODE FOR VARIANT
 SPECIFICATION.

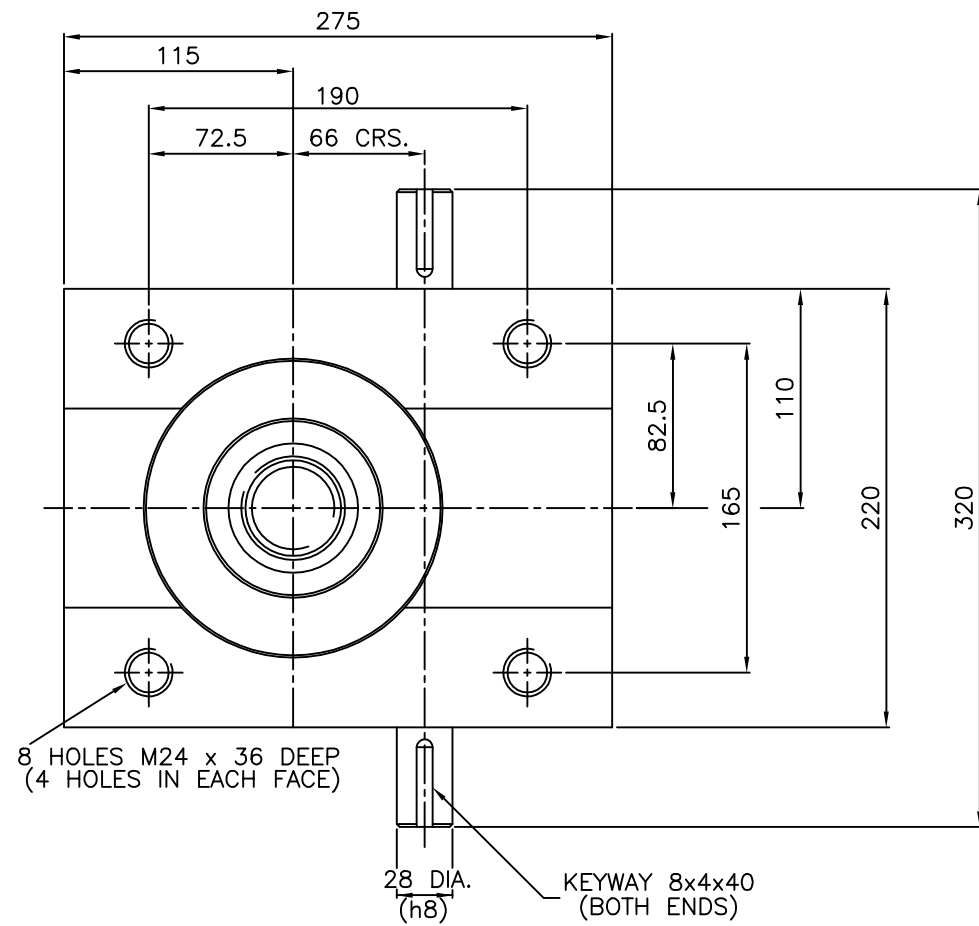

IF TOP PLATES OR CLEVIS ENDS ARE NOT ALREADY
 FITTED, IT WILL BE NECESSARY TO DRILL-DIMPLE
 FITTING SCREW THREADING TO ACCOMODATE
 CUP-POINTS OF LOCKING-SCREWS.
 NOTE - DIMPLE TO FULL DIAMETER OF DRILL TO
 1mm-1.5mm BELOW ROOT DIA. OF THREAD.

